

HOLIDAY KEEPER

HOLIDAY DECORATION STORAGE BAG

ASSEMBLY INSTRUCTIONS

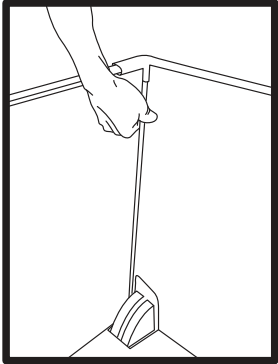

<< STEP 1

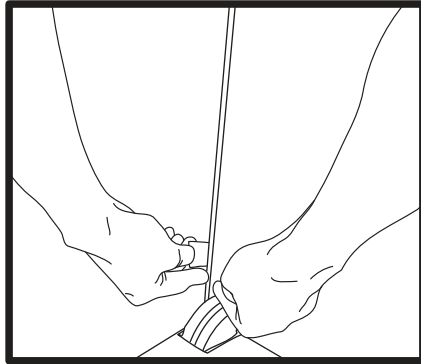

<< STEP 2

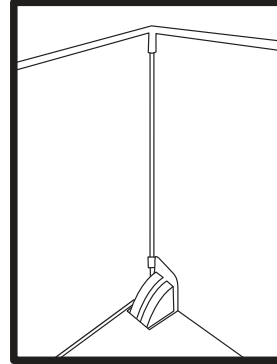

<< STEP 3

STEP 1: Insert one of the shorter four rods into the bottom slot, then attach to top slot.

STEP 2: At the bottom of each corner slot is a velcro fastener that should be wrapped around the rods in each of the corners.

STEP 3: Repeat steps 1 & 2 in each of the four corners. Finished corners should look like illustration STEP 3

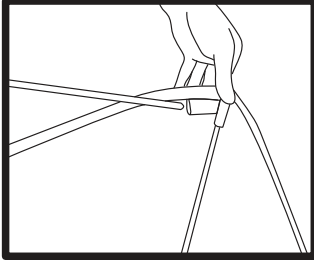

<< STEP 4

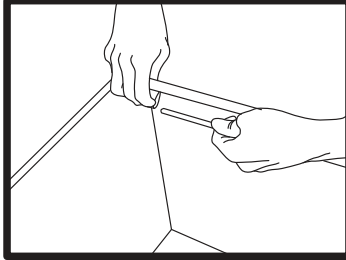

<< STEP 5

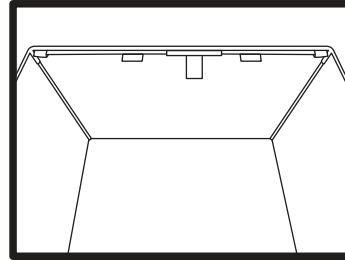

<< STEP 6

STEP 4: Insert one of the longer two rods into the right corner slot.

STEP 5: Attach the opposite end of the longer rod to the left corner.

STEP 6: Repeat steps 4 & 5 in each of the opposite end. Finished sides should look like illustration STEP 6

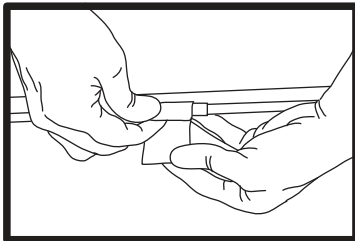

<< STEP 7

STEP 7: Wrap velcro fastener around middle of each side.